

Fluid control valve(2/2way)

2S Series (Direct-acting and normally closed)



Symbol



Product feature

1. Direct acting and normally closed type 2/2 way solenoid valve. Its high sensibility allows it to change direction quickly;
2. It has wide pressure range, including extra high pressure (X), high pressure (H), standard, large volume(L) and extra large volume (T) to choose from;
3. It is compact, small size and light weight. It is easy to install and dismantle.
4. The valve body is made of SUS304. Its coil has a Heat resistance classification of Class B. The standard seal material is FPM-F. Please contact us if other material are required.
5. The protection class of the coil is IP65 and there is a choice for grommet or terminal electrical entry.

Inner structure

2S030(Terminal)

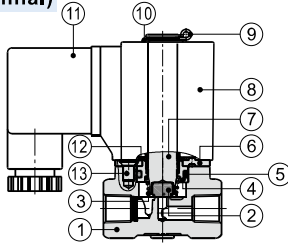

| No. | Item | No. | Item |
|-----|---------------|-----|---------------|
| 1 | Body | 8 | Coil assembly |
| 2 | Airtight ring | 9 | E Clip |
| 3 | Spring | 10 | Gasket |
| 4 | Fixed cap | 11 | Connector |
| 5 | O-ring | 12 | Washer |
| 6 | Fixed plate | 13 | Screw |
| 7 | Movable core | | |

Specification

| Model\Item | Port size [Note1] | Orifice size (Φmm) | Cv | Valid area or section (mm ²) | Weight [Note2](g) | Max.operating pressure differential | | Proof pressure | |
|------------|-------------------|--------------------|------|--|-------------------|-------------------------------------|-----|----------------|-----|
| | | | | | | MPa | psi | MPa | psi |
| 2SX030 | -06 1/8" | 1.5 | 0.10 | 1.8 | 300 | 3.0 | 450 | 5.0 | 750 |
| | -08 1/4" | | | | 295 | | | | |
| 2SH030 | -06 1/8" | 2.0 | 0.18 | 3.0 | 300 | 2.0 | 300 | | |
| | -08 1/4" | | | | 290 | | | | |
| 2S030 | -06 1/8" | 3.0 | 0.33 | 6.0 | 300 | 1.0 | 150 | | |
| | -08 1/4" | | | | 290 | | | | |
| 2SL030 | -06 1/8" | 4.0 | 0.55 | 10.0 | 300 | 0.5 | 75 | | |
| | -08 1/4" | | | | 290 | | | | |
| 2ST030 | -06 1/8" | 6.0 | 1.10 | 12.0 | 300 | 0.1 | 15 | | |
| | -08 1/4" | | | | 290 | | | | |
| 2SX050 | -10 3/8" | 3.0 | 0.34 | 6.1 | 600 | 3.0 | 450 | | |
| | -15 1/2" | | | | 590 | | | | |
| 2SH050 | -10 3/8" | 4.0 | 0.55 | 10.0 | 600 | 2.0 | 300 | | |
| | -15 1/2" | | | | 590 | | | | |
| 2S050 | -10 3/8" | 5.0 | 0.83 | 15.0 | 600 | 1.0 | 150 | | |
| | -15 1/2" | | | | 590 | | | | |
| 2SL050 | -10 3/8" | 7.0 | 1.40 | 25.0 | 600 | 0.5 | 75 | | |
| | -15 1/2" | | | | 590 | | | | |
| 2ST050 | -10 3/8" | 10.0 | 2.20 | 40.0 | 600 | 0.1 | 15 | | |
| | -15 1/2" | | | | 590 | | | | |

[Note1] PT thread, G thread and NPT thread are available.

[Note2] The weight in the table is the terminal valve's weight, 2S030 series grommet valve's weight is 10g less than terminal's. 2S050series grommet valve's weight is 20g less than terminal's.

Specification of coil

| Valve type | Coil type | Power type | Frequency (Hz) | Voltage range | Electrical entry | Power Consumption (VA/W) | Insulation | Temp. rise(°C) | |
|------------|------------------|------------|----------------|---------------|------------------|--------------------------|------------|----------------|--------|
| 2S□030 | CDA116 CLA116 | AC | 50 | ±15% | Terminal (CDA) | 10.0VA | Class B | 35 | |
| | | | 60 | | | 8.0VA | | 30 | |
| | | DC | - | ±10% | | 6.5W | | 30 | |
| 2S□050 | CDA170 CLA170 | AC | 50 | ±15% | Grommet (CLA) | 25.0VA | | Class B | 60 |
| | | | 60 | | | ±10% | | | 22.0VA |
| | | DC | - | ±10% | | 12.0W | | | 40 |

Valve's specification

| Acting | | Direct acting | | | |
|--------------------------------------|------|-----------------|-------------|-------------|---------|
| Initial state | | Normally closed | | | |
| Adaptable fluid | | Air, Water, Oil | | | |
| Viscosity limit | | Under 20CST | | | |
| Ambient and fluid temperature (°C) | | Water | Air | Oil | Ambient |
| | Max. | 80 | 90 | 80 | 70 |
| | Min. | 1 | -20 [Note1] | -10 [Note2] | -20 |

[Note1] Dew point: -20(°C) or less ;

[Note2] 50CST or less.

Ordering code

Ordering code of valves

2S L 030 08 A □ □



| ①Model | ②Pressure condition | ③Size series | ④Port size | ⑤Voltage | ⑥Electrical entry | ⑦Thread type |
|---|---|------------------------------------|--|--|-------------------------------------|-----------------------------|
| 2S: 2/2 way direct-acting and normally closed | X: Extra high pressure H: High pressure Blank: Standard L: Large volume T: Extra large volume | 030: 030 Series 050: 050 Series | 06: 1/8" 08: 1/4" 10: 3/8" 15: 1/2" | A: AC220V B: DC24V C: AC110V E: AC24V F: DC12V | Blank: Terminal I: Grommet[Note] | Blank: PT G: G T: NPT |

Ordering code of accessories

F-2S030 LB



| ①Accessories code | ②Valve type | ③Accessories type |
|-------------------------|--|-------------------|
| F: Mounting accessories | 2S030: 030 Series valve 2S050: 050 Series valve | LB: LB Type |

[Note] The wire length is 0.5m.



Fluid control valve(2/2way)

2S Series (Direct-acting and normally closed)

Flow chart

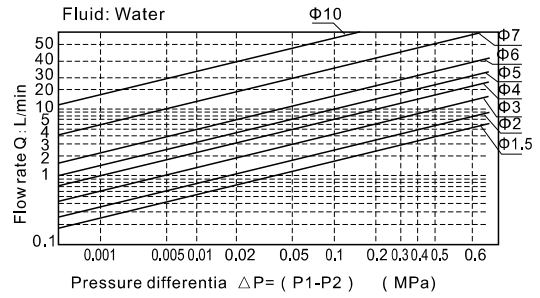
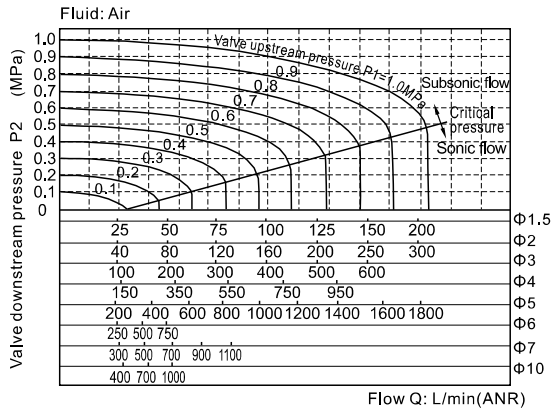

Dimensions

2S□030 (Terminal)

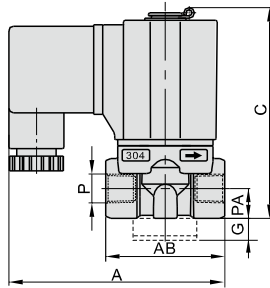
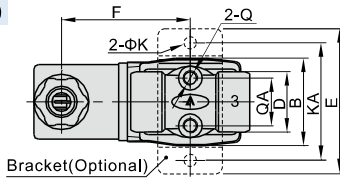

2S□030 (Grommet)

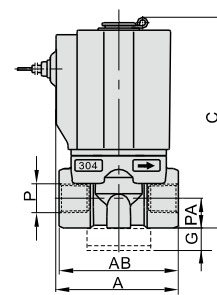
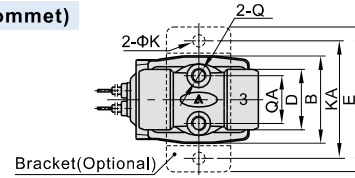

2S□050 (Terminal)

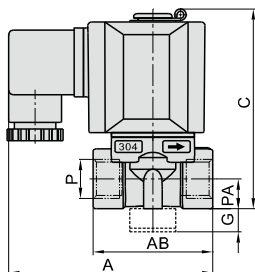
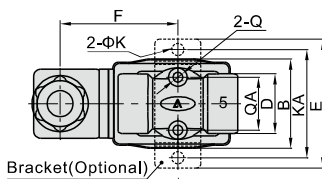

2S□050 (Grommet)

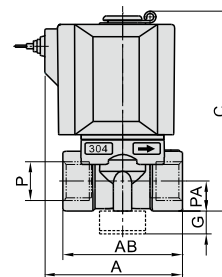
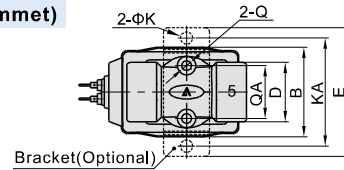

| Model/Item | A | AB | B | C | D | E | F | G | K | KA | P | PA | Q | QA |
|------------|------|----|------|----|----|----|------|----|-----|----|------|----|----|----|
| 2S□030-06 | 72.5 | 40 | 29.5 | 71 | 20 | 49 | 43.5 | 10 | 5.3 | 40 | 1/8" | 10 | M5 | 16 |
| 2S□030-08 | 72.5 | 40 | 29.5 | 71 | 20 | 49 | 43.5 | 10 | 5.3 | 40 | 1/4" | 10 | M5 | 16 |
| 2S□050-10 | 89.5 | 52 | 39 | 87 | 26 | 56 | 51 | 10 | 5.3 | 48 | 3/8" | 13 | M5 | 23 |
| 2S□050-15 | 89.5 | 52 | 39 | 87 | 26 | 56 | 51 | 10 | 5.3 | 48 | 1/2" | 13 | M5 | 23 |

| Model/Item | A | AB | B | C | D | E | G | K | KA | P | PA | Q | QA |
|------------|----|----|------|----|----|----|----|-----|----|------|----|----|----|
| 2S□030-06 | 41 | 40 | 29.5 | 71 | 20 | 49 | 10 | 5.3 | 40 | 1/8" | 10 | M5 | 16 |
| 2S□030-08 | 41 | 40 | 29.5 | 71 | 20 | 49 | 10 | 5.3 | 40 | 1/4" | 10 | M5 | 16 |
| 2S□050-10 | 60 | 52 | 39 | 87 | 26 | 56 | 10 | 5.3 | 48 | 3/8" | 13 | M5 | 23 |
| 2S□050-15 | 60 | 52 | 39 | 87 | 26 | 56 | 10 | 5.3 | 48 | 1/2" | 13 | M5 | 23 |

Fluid control valve(2/2way)

2S Series (Internally piloted and normally closed)

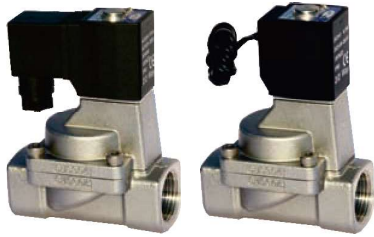

Symbol



Product feature

1. Indirect acting (Internal pilot) and normally closed type 2/2 way solenoid valve. It can change direction quickly and has large flow.
2. It is compact, small and light weight. It is easy to install and dismantle;
3. The valve body is made of SUS304. The coil has a Heat resistance classification of Class B. The standard seal material is FPM-F. Please contact us if other material are required.
4. The protection class of the coil is IP65 and there is a choice for grommet or terminal electrical entry.

Inner structure

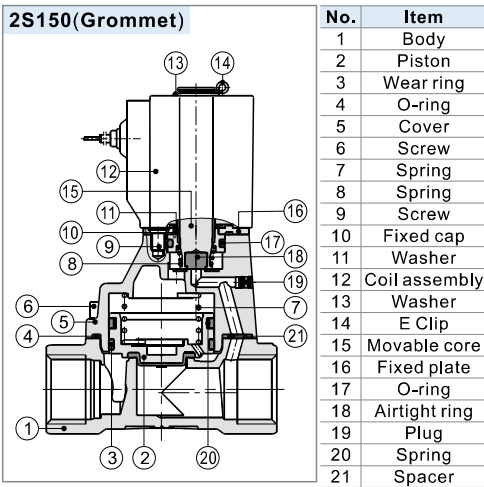

Ordering code

Ordering code of valves

| ① Model | ② Orifice size | ③ Port size | ④ Voltage | ⑤ Electrical entry | ⑥ Thread type |
|--|----------------|-------------|--|---|-----------------------------|
| 2S: 2/2 way internally piloted and normally closed | 150: Φ15mm | 15: 1/2" | A: AC220V B: DC24V C: AC110V E: AC24V F: DC12V | Blank: Terminal I: Grommet [Note] | Blank: PT G: G T: NPT |
| | 200: Φ20mm | 20: 3/4" | | | |
| | 250: Φ25mm | 25: 1" | | | |
| | 320: Φ35mm | 32: 1 1/4" | | | |
| | 400: Φ40mm | 40: 1 1/2" | | | |
| 500: Φ50mm | 50: 2" | | | | |

[Note] The wire length is 0.5m.

Ordering code of accessories

| ① Accessories code | ② Valve type | ③ Accessories type |
|-------------------------|---|--------------------|
| F: Mounting accessories | 2S150: 150 Series valve 2S200: 200 Series valve 2S250: 250 Series valve | LB: LB Type |

[[Note] 320\400\500 series valves do not have mounting accessories.

Specification

| Model/Item | Port size [Note1] | Orifice size (Φmm) | Cv | Valid area or section (mm ²) | Weight [Note2](g) | Operating pressure differential | | Proof pressure | |
|------------|----------------------|-----------------------|-------|--|----------------------|---------------------------------|---------------------|----------------|-----|
| | | | | | | MPa | psi | MPa | psi |
| 2S150-15 | 1/2" | 15.0 | 5.50 | 100.0 | 675 | Max: 1.0 Min: 0.05 | Max: 150 Min: 10 | 1.5 | 220 |
| 2S200-20 | 3/4" | 20.0 | 9.50 | 170.0 | 875 | | | | |
| 2S250-25 | 1 | 25.0 | 12.50 | 220.0 | 1120 | | | | |
| 2S320-32 | 1 1/4" | 35.0 | 23.00 | 420.0 | 2700 | | | | |
| 2S400-40 | 1 1/2" | 40.0 | 31.00 | 560.0 | 3250 | | | | |
| 2S500-50 | 2" | 50.0 | 49.00 | 880.0 | 4300 | | | | |

[Note1] PT thread, G thread and NPT thread are available.

[Note2] The weight in the table is the terminal valve's weight, 2S150~250 series grommet valve's weight is 10g less than terminal's, 2S320~500 series grommet valve's weight is 20g less than terminal's.

Specification of coil

| Valve type | Coil type | Power type | Frequency (Hz) | Voltage range | Electrical entry | Power Consumption (VA/W) | Insulation | Temp. rise(°C) |
|-------------------------|------------------|------------|----------------|---------------|-------------------------------------|--------------------------|------------|----------------|
| 2S150 2S200 2S250 | CDA116 CLA116 | AC | 50 | ±15% | Terminal (CDA) Grommet (CLA) | 10.0VA | Class B | 35 |
| | | | 60 | | | 8.0VA | | 30 |
| 2S320 2S400 2S500 | CDA170 CLA170 | AC | - | ±10% | | 6.5W | | 30 |
| | | | 50 | | | 25.0VA | | 60 |
| | | | 60 | 22.0VA | | 55 | | |
| | | | - | ±10% | | 12.0W | | 40 |

Valve's specification

| Acting | Internally piloted | | | | |
|--------------------------------------|--------------------|-------|-------------|-------------|---------|
| Initial state | Normally closed | | | | |
| Adaptable fluid | Air, Water, Oil | | | | |
| Viscosity limit | Under 20CST | | | | |
| Ambient and fluid temperature (°C) | | Water | Air | Oil | Ambient |
| | Max. | 80 | 90 | 80 | 70 |
| | Min. | 1 | -20 [Note1] | -10 [Note2] | -20 |

[Note1] Dew point: -20(°C) or less ; [Note2] 50CST or less.



Fluid control valve(2/2way)

2S Series (Internally piloted and normally closed)

Flow chart

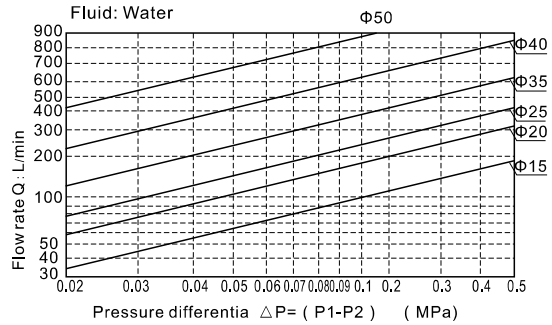
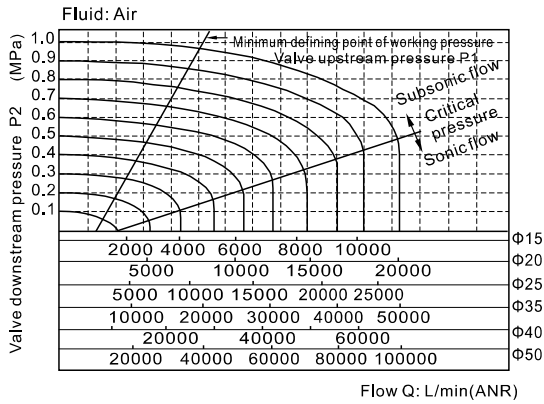

Dimensions

2S150~250 (Terminal)

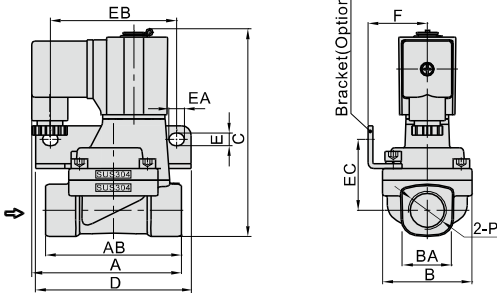

2S150~250(Grommet)

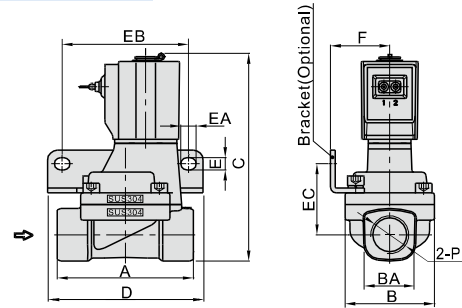

2S320~500 (Terminal)

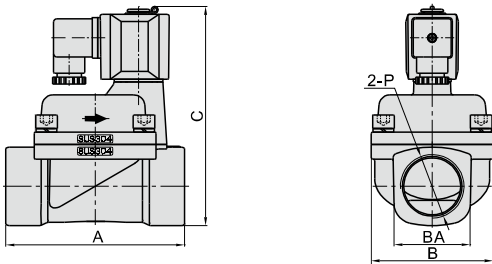

2S320~500(Grommet)

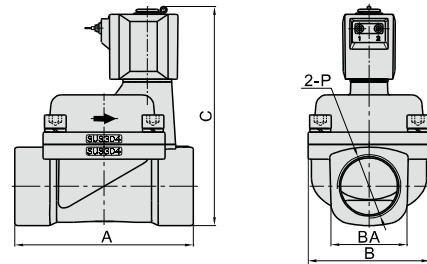

| Model/Item | A | AB | B | BA | C | D | E | EA | EB | EC | F | P |
|------------|------|----|-----|------|-------|----|-----|----|----|------|------|--------|
| 2S150-15 | 77 | 70 | 46 | 27.5 | 107 | 80 | 6.4 | 8 | 65 | 36.5 | 30.5 | 1/2" |
| 2S200-20 | 78.5 | 82 | 53 | 33.5 | 115.5 | 90 | 6.4 | 8 | 75 | 40 | 34 | 3/4" |
| 2S250-25 | 81 | 92 | 59 | 40.5 | 124 | 95 | 6.4 | 8 | 80 | 44.5 | 36 | 1 |
| 2S320-32 | 125 | - | 80 | 52 | 154.5 | - | - | - | - | - | - | 1 1/4" |
| 2S400-40 | 132 | - | 90 | 58 | 162 | - | - | - | - | - | - | 1 1/2" |
| 2S500-50 | 150 | - | 100 | 70 | 177 | - | - | - | - | - | - | 2" |

| Model/Item | A | B | BA | C | D | E | EA | EB | EC | F | P |
|------------|-----|-----|------|-------|----|-----|----|----|------|------|--------|
| 2S150-15 | 70 | 46 | 27.5 | 107 | 80 | 6.4 | 8 | 65 | 36.5 | 30.5 | 1/2" |
| 2S200-20 | 82 | 53 | 33.5 | 115.5 | 90 | 6.4 | 8 | 75 | 40 | 34 | 3/4" |
| 2S250-25 | 92 | 59 | 40.5 | 124 | 95 | 6.4 | 8 | 80 | 44.5 | 36 | 1 |
| 2S320-32 | 125 | 80 | 52 | 154.5 | - | - | - | - | - | - | 1 1/4" |
| 2S400-40 | 132 | 90 | 58 | 162 | - | - | - | - | - | - | 1 1/2" |
| 2S500-50 | 150 | 100 | 70 | 177 | - | - | - | - | - | - | 2" |

Fluid control valve(2/2 way)

2KS Series (Direct-acting and normally opened)



Symbol



Product feature

1. Direct acting and normally opened type 2/2 way solenoid valve. Its high sensibility allows it to change direction quickly;
2. It has wide pressure range, including extra high pressure (X), high pressure (H), standard and large volume(L) to choose from;
3. It is compact, small size and light weight. It is easy to install and dismantle.
4. The valve body is made of SUS304 . Its coil has a Heat resistance classification of Class B. The standard seal material is FPM-F. Please contact us if other material are required.
5. The protection class of the coil is IP65 and there is a choice for grommet or terminal electrical entry .

Inner structure

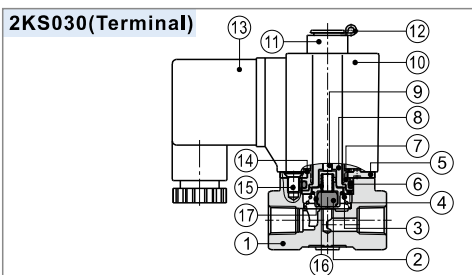

| No. | Item | No. | Item |
|-----|---------------|-----|---------------|
| 1 | Body | 10 | Coil assembly |
| 2 | Airtight ring | 11 | Position ring |
| 3 | Spring | 12 | E Clip |
| 4 | Bead flange | 13 | Connector |
| 5 | Fixed plate | 14 | Washer |
| 6 | O-ring | 15 | Screw |
| 7 | Fixed cap | 16 | Spring |
| 8 | Electromagnet | 17 | Airtight bush |
| 9 | Mandril | | |

Specification

| Model/Item | Port size [Note1] | Orifice size (Φmm) | Cv | Valid area or section (mm ²) | Weight [Note2](g) | Max.operating pressure differential | | Proof pressure | |
|------------|----------------------|-----------------------|------|---|----------------------|-------------------------------------|-----|----------------|-----|
| | | | | | | MPa | psi | MPa | psi |
| 2KXS030 | -06 1/8" | 1.5 | 0.10 | 1.8 | 305 | 2.0 | 300 | 3.0 | 450 |
| | -08 1/4" | | | | | | | | |
| 2KSH030 | -06 1/8" | 2.0 | 0.18 | 3.0 | 305 | 1.5 | 220 | | |
| | -08 1/4" | | | | | | | | |
| 2KS030 | -06 1/8" | 3.0 | 0.33 | 6.0 | 305 | 0.7 | 100 | | |
| | -08 1/4" | | | | | | | | |
| 2KSL030 | -06 1/8" | 4.0 | 0.55 | 10.0 | 305 | 0.4 | 60 | | |
| | -08 1/4" | | | | | | | | |
| 2KXS050 | -10 3/8" | 3.0 | 0.34 | 6.1 | 610 | 2.0 | 300 | | |
| | -15 1/2" | | | | | | | | |
| 2KSH050 | -10 3/8" | 4.0 | 0.55 | 10.0 | 610 | 1.5 | 220 | | |
| | -15 1/2" | | | | | | | | |
| 2KS050 | -10 3/8" | 5.0 | 0.83 | 15.0 | 610 | 0.7 | 100 | | |
| | -15 1/2" | | | | | | | | |
| 2KSL050 | -10 3/8" | 7.0 | 1.40 | 25.0 | 610 | 0.4 | 60 | | |
| | -15 1/2" | | | | | | | | |

[Note1] PT thread, G thread and NPT thread are available.

[Note2] The weight in the table is the terminal valve's weight, 2KS030 series grommet valve's weight is 10g less than terminal's, 2KS050series grommet valve's weight is 20g less than terminal's.

Specification of coil

| Valve type | Coil type | Power type | Frequency (Hz) | Voltage range | Electrical entry | Power Consumption (VA/W) | Insulation | Temp. rise(°C) | |
|------------|------------------|------------|----------------|---------------|-------------------|--------------------------|------------|----------------|----|
| 2KS□030 | CDA116 CLA116 | AC | 50 | ±15% | Terminal (CDA) | 15.0VA | Class B | 50 | |
| | | | 60 | | | 11.0VA | | 40 | |
| | | DC | - | ±10% | | 6.5W | | 30 | |
| 2KS□050 | CDA170 CLA170 | AC | 50 | ±15% | Grommet (CLA) | 35.0VA | | Class B | 65 |
| | | | 60 | | | 30.0VA | | | 60 |
| | | DC | - | ±10% | | 12.0W | | | 40 |

Valve's specification

| Acting | | Direct acting | | | |
|--------------------------------------|------|-----------------|-------------|-------------|---------------|
| Initial state | | Normally opened | | | |
| Adaptable fluid | | Air, Water, Oil | | | |
| Viscosity limit | | Under 20CST | | | |
| Ambient and fluid temperature (°C) | Max. | Water 80 | Air 90 | Oil 80 | Ambient 70 |
| | Min. | 1 | -20 [Note1] | -10 [Note2] | -20 |

[Note1] Dew point: -20(°C) or less ;

[Note2] 50CST or less.

Ordering code

Ordering code of valves

2KS H 030 08 A □ □

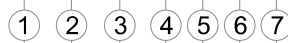

| ① Model | ② Pressure condition | ③ Size series | ④ Port size | ⑤ Voltage | ⑥ Electrical entry | ⑦ Thread type |
|--|--|------------------------------------|--|--|-------------------------------------|-----------------------------|
| 2KS: 2/2 way direct-acting and normally opened | X: Extra high pressure H: High pressure Blank: Standard L: Large volume | 030: 030 Series 050: 050 Series | 06: 1/8" 08: 1/4" 10: 3/8" 15: 1/2" | A: AC220V B: DC24V C: AC110V E: AC24V F: DC12V | Blank: Terminal I: Grommet[Note] | Blank: PT G: G T: NPT |

Ordering code of accessories

Ordering code of accessories is the same as 2S series valve's, Please refer to P194 for details of ordering code.

[Note] The wire length is 0.5m.



Fluid control valve(2/2 way)

2KS Series (Direct-acting and normally opened)



Flow chart

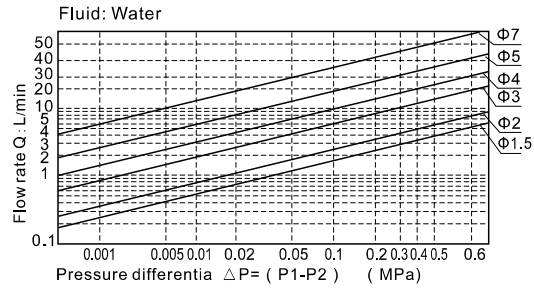
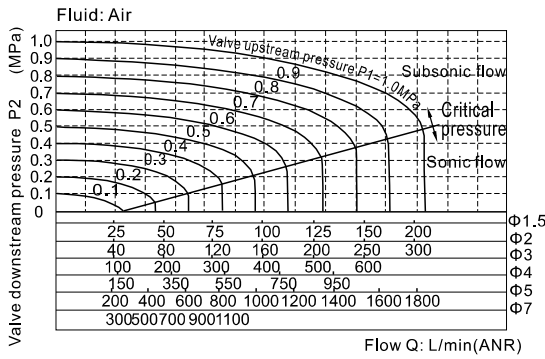

Dimensions

2KS□030 (Terminal)

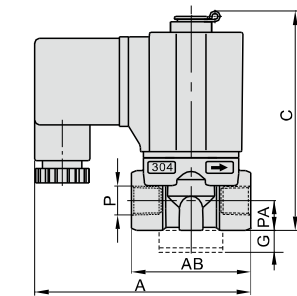
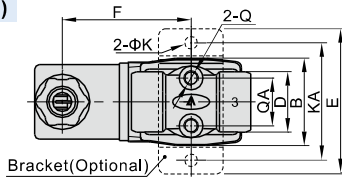

2KS□030 (Grommet)

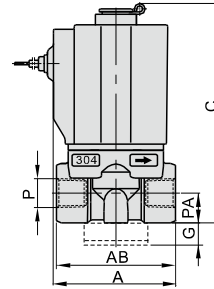
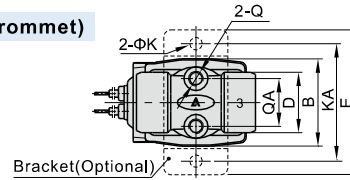

2KS□050 (Terminal)

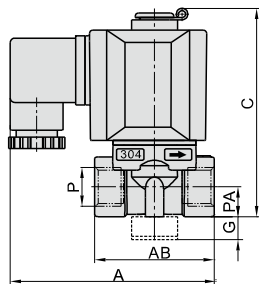
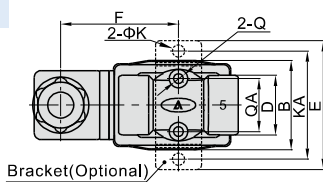

2KS□050 (Grommet)

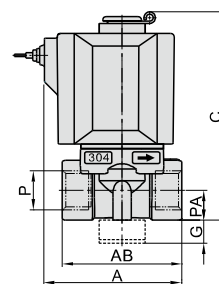
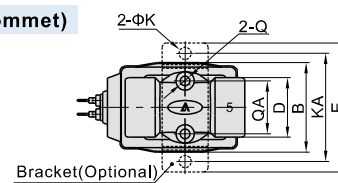

| Model\Item | A | AB | B | C | D | E | F | G | K | KA | P | PA | Q | QA |
|------------|------|----|------|----|----|----|------|----|-----|----|------|----|----|----|
| 2KS□030-06 | 72.5 | 40 | 29.5 | 76 | 20 | 49 | 43.5 | 10 | 5.3 | 40 | 1/8" | 10 | M5 | 16 |
| 2KS□030-08 | 72.5 | 40 | 29.5 | 76 | 20 | 49 | 43.5 | 10 | 5.3 | 40 | 1/4" | 10 | M5 | 16 |
| 2KS□050-10 | 89.5 | 52 | 39 | 92 | 26 | 56 | 51 | 10 | 5.3 | 48 | 3/8" | 13 | M5 | 23 |
| 2KS□050-15 | 89.5 | 52 | 39 | 92 | 26 | 56 | 51 | 10 | 5.3 | 48 | 1/2" | 13 | M5 | 23 |

| Model\Item | A | AB | B | C | D | E | G | K | KA | P | PA | Q | QA |
|------------|----|----|------|----|----|----|----|-----|----|------|----|----|----|
| 2KS□030-06 | 41 | 40 | 29.5 | 76 | 20 | 49 | 10 | 5.3 | 40 | 1/8" | 10 | M5 | 16 |
| 2KS□030-08 | 41 | 40 | 29.5 | 76 | 20 | 49 | 10 | 5.3 | 40 | 1/4" | 10 | M5 | 16 |
| 2KS□050-10 | 60 | 52 | 39 | 92 | 26 | 56 | 10 | 5.3 | 48 | 3/8" | 13 | M5 | 23 |
| 2KS□050-15 | 60 | 52 | 39 | 92 | 26 | 56 | 10 | 5.3 | 48 | 1/2" | 13 | M5 | 23 |



Fluid control valve(2/2 way)

2KS Series (Internally piloted and normally opened)

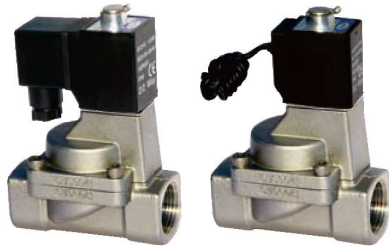

Symbol



Product feature

1. Indirect acting (Internal pilot) and normally opened type 2/2 way solenoid valve. It can change direction quickly and has large flow.
2. It is compact, small and light weight. It is easy to install and dismantle;
3. The valve body is made of SUS304. The coil has a Heat resistance classification of Class B. The standard seal material is FPM-F. Please contact us if other material are required.
4. The protection class of the coil is IP65 and there is a choice for grommet or terminal electrical entry.

Inner structure

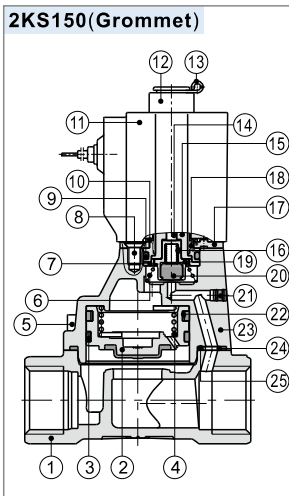

| No. | Item |
|-----|------------------|
| 1 | Body |
| 2 | Piston |
| 3 | Wear ring |
| 4 | Spring |
| 5 | Screw |
| 6 | Spring |
| 7 | Fixed ring |
| 8 | Screw |
| 9 | O-ring |
| 10 | Washer |
| 11 | Coil assembly |
| 12 | Position ring |
| 13 | E Clip |
| 14 | Mandril |
| 15 | Movable core |
| 16 | Spring |
| 17 | Fixed plate |
| 18 | Fixed cap |
| 19 | Airtight bushing |
| 20 | Airtight ring |
| 21 | Plug |
| 22 | Spring |
| 23 | Cover |
| 24 | Spacer |
| 25 | O-ring |

Ordering code

Ordering code of valves

2KS 150 15 A □ □

① ② ③ ④ ⑤ ⑥

| ① Model | ② Orifice size | ③ Port size | ④ Voltage | ⑤ Electrical entry | ⑥ Thread type |
|---|----------------|-------------|--|---|-----------------------------|
| 2KS: 2/2 way internally piloted and normally opened | 150: φ15mm | 15: 1/2" | A: AC220V B: DC24V C: AC110V E: AC24V F: DC12V | Blank: Terminal I: Grommet [Note] | Blank: PT G: G T: NPT |
| | 200: φ20mm | 20: 3/4" | | | |
| | 250: φ25mm | 25: 1" | | | |
| | 320: φ35mm | 32: 1 1/4" | | | |
| | 400: φ40mm | 40: 1 1/2" | | | |
| 500: φ50mm | 50: 2" | | | | |

[Note] The wire length is 0.5m.

Specification

| Model\Item | Port size [Note1] | Orifice size (Φmm) | Cv | Valid area or section (mm ²) | Weight [Note2](g) | Operating pressure differential | | Proof pressure | |
|------------|----------------------|-----------------------|-------|---|----------------------|---------------------------------|---------------------|----------------|-----|
| | | | | | | MPa | psi | MPa | psi |
| 2KS150-15 | 1/2" | 15.0 | 5.50 | 100.0 | 680 | Max: 0.7 Min: 0.05 | Max: 100 Min: 10 | 1.5 | 220 |
| 2KS200-20 | 3/4" | 20.0 | 9.50 | 170.0 | 880 | | | | |
| 2KS250-25 | 1 | 25.0 | 12.50 | 220.0 | 1125 | | | | |
| 2KS320-32 | 1 1/4" | 35.0 | 23.00 | 420.0 | 2710 | | | | |
| 2KS400-40 | 1 1/2" | 40.0 | 31.00 | 560.0 | 3260 | | | | |
| 2KS500-50 | 2" | 50.0 | 49.00 | 880.0 | 4310 | | | | |

[Note1] PT thread, G thread and NPT thread are available.

[Note2] The weight in the table is the terminal valve's weight, 2KS150~250 series grommet valve's weight is 10g less than terminal's, 2KS320~500 series grommet valve's weight is 20g less than terminal's.

Specification of coil

| Valve type | Coil type | Power type | Frequency (Hz) | Voltage range | Electrical entry | Power Consumption (VA/W) | Insulation | Temp. rise(°C) |
|----------------------------|------------------|------------|----------------|---------------|-------------------------------------|--------------------------|------------|----------------|
| 2KS150 2KS200 2KS250 | CDA116 CLA116 | AC | 50 | ±15% | Terminal (CDA) Grommet (CLA) | 15.0VA | Class B | 50 |
| | | | 60 | | | 11.0VA | | 40 |
| 2KS320 2KS400 2KS500 | CDA170 CLA170 | AC | 50 | ±15% | | 35.0VA | | 65 |
| | | | 60 | | | 30.0VA | | 60 |
| | | DC | - | ±10% | 12.0W | 40 | | |

Valve's specification

| Acting | Internally piloted | | | | |
|--------------------------------------|--------------------|-------|-------------|-------------|---------|
| Initial state | Normally opened | | | | |
| Adaptable fluid | Air, Water, Oil | | | | |
| Viscosity limit | Under 20CST | | | | |
| Ambient and fluid temperature (°C) | | Water | Air | Oil | Ambient |
| | Max. | 80 | 90 | 80 | 70 |
| | Min. | 1 | -20 [Note1] | -10 [Note2] | -20 |

[Note1] Dew point: -20(°C) or less ; [Note2] 50CST or less.



Fluid control valve(2/2 way)

2KS Series (Internally piloted and normally opened)

Flow chart

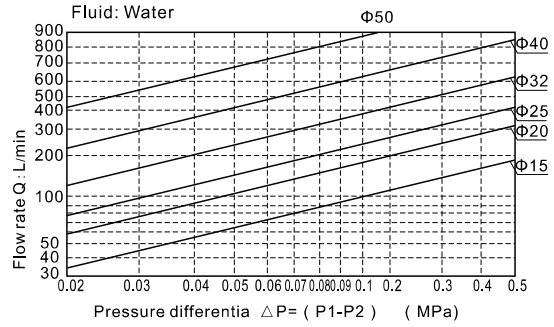
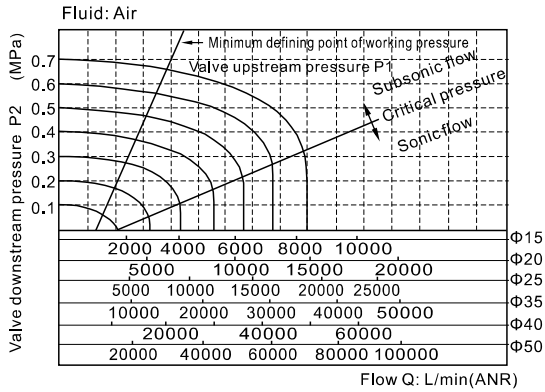

Dimensions

2KS150~250 (Terminal)

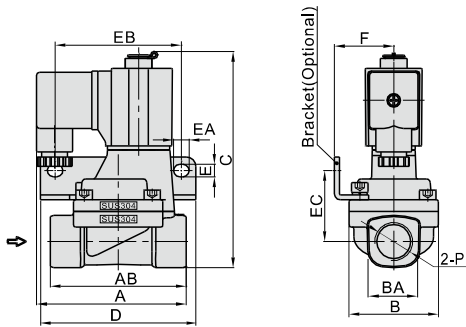

2KS150~250(Grommet)

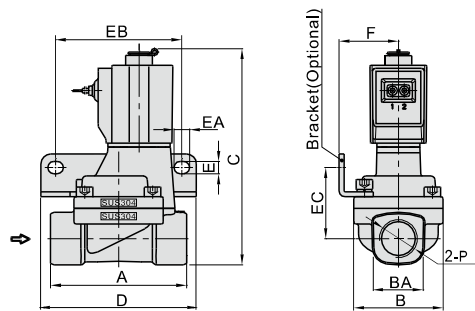

2KS320~500 (Terminal)

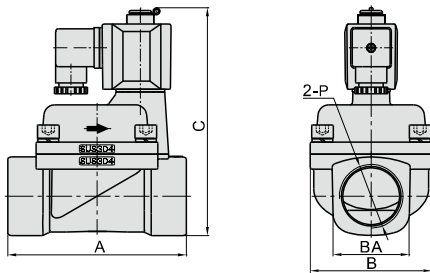

2KS320~500(Grommet)

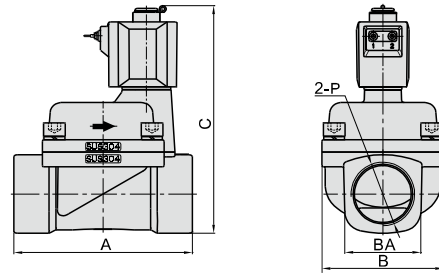

| Model\Item | A | AB | B | BA | C | D | E | EA | EB | EC | F | P |
|------------|------|----|-----|------|-------|----|-----|----|----|------|------|--------|
| 2KS150-15 | 77 | 70 | 46 | 27.5 | 112.5 | 80 | 6.4 | 8 | 65 | 36.5 | 30.5 | 1/2" |
| 2KS200-20 | 78.5 | 82 | 53 | 33.5 | 121 | 90 | 6.4 | 8 | 75 | 40 | 34 | 3/4" |
| 2KS250-25 | 81 | 92 | 59 | 40.5 | 129.5 | 95 | 6.4 | 8 | 80 | 44.5 | 36 | 1 |
| 2KS320-32 | 125 | - | 80 | 52 | 160 | - | - | - | - | - | - | 1 1/4" |
| 2KS400-40 | 132 | - | 90 | 58 | 167 | - | - | - | - | - | - | 1 1/2" |
| 2KS500-50 | 150 | - | 100 | 70 | 182 | - | - | - | - | - | - | 2" |

| Model\Item | A | B | BA | C | D | E | EA | EB | EC | F | P |
|------------|-----|-----|------|-------|----|-----|----|----|------|------|--------|
| 2KS150-15 | 70 | 46 | 27.5 | 112.5 | 80 | 6.4 | 8 | 65 | 36.5 | 30.5 | 1/2" |
| 2KS200-20 | 82 | 53 | 33.5 | 121 | 90 | 6.4 | 8 | 75 | 40 | 34 | 3/4" |
| 2KS250-25 | 92 | 59 | 40.5 | 129.5 | 95 | 6.4 | 8 | 80 | 44.5 | 36 | 1 |
| 2KS320-32 | 125 | 80 | 52 | 160 | - | - | - | - | - | - | 1 1/4" |
| 2KS400-40 | 132 | 90 | 58 | 167 | - | - | - | - | - | - | 1 1/2" |
| 2KS500-50 | 150 | 100 | 70 | 182 | - | - | - | - | - | - | 2" |